

VTK-HYST21-010 - SHELVING KIT SPECIFICATIONS

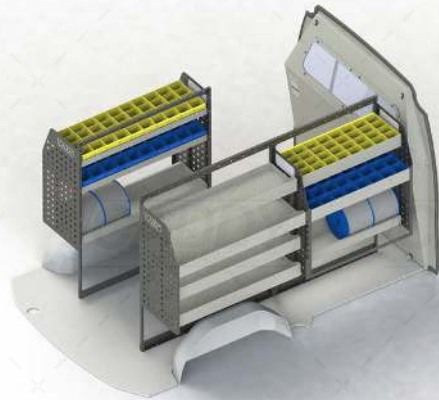

DRIVER SIDE FRONT

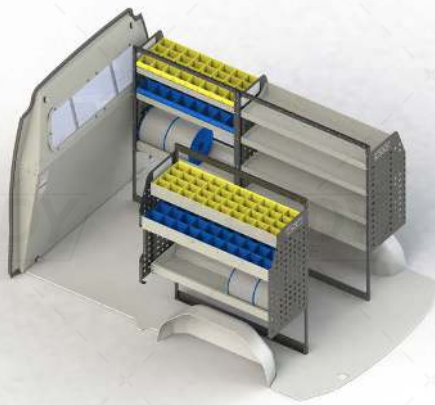

ADJ09-G

Unit Size: 850mm w x 1290mm h

End panels: Standard Panels

No. of shelves: 3 (Including 1x Cable Shelf, 1x Bottom Bar)

Shelf Depth: 310mm (Row 1), 410mm (Row 2), Cable Shelf (Row 3)

Plastic Bins: 8 x PBC 3.0, 8 x PBC 4.0

DRIVER SIDE REAR



ADJ01-H SPEC L

Unit Size: 1080mm w x 1290mm h

End panels: Standard Panel Right, Special Left

No. of shelves: 4

Shelf Depth: 310mm (Row 1), 410mm (Row 2), 350mm (Rows 3-4)

Plastic Bins: None

PASSENGER SIDE REAR



ADJ09-H SPEC R

Unit Size: 1080mm w x 1290mm h

End panels: Standard Panel Left, Special Right

No. of shelves: 3 (Including 1x Cable Shelf, 1x Bottom Bar)

Shelf Depth: 310mm (Row 1), 410mm (Row 2), Cable Shelf (Row 3)

Plastic Bins: 10 x PBC 3.0, 10 x PBC 4.0

VTK-HYST21-010 TO SUIT THE FOLLOWING:

Model: Staria-Load

Make: Hyundai

Year: 08/2021+

Please check manufacturing plate for the make and model of your vehicle.

Cargo barrier and flooring depicted in images not included in Trade Kit. These accessories are available separately.

CADDY
STORAGE